



A futuristic and stylish LED brand.

House of LED Modules

NEBULA Series



☎ **848-350-2833**

🌐 www.vjledusa.com

✉ contact@vjledusa.com



CRYSTAL HE SLIM LED MODULE

True 1 inch solution



Features

- Using high efficiency LEDs, luminous efficiency can be up to 130LM/W.
- Beam angle 170°, can be used for 2.5CM thick light boxes and channel letters.
- DC 24V constant voltage, 50/30/20 PCS per string.
- UL, CE, RoHS certified.

Application

- Suitable for 2.5-10CM thick single-sided light boxes and channel letters used at both indoor and outdoor places such as bus stops, shopping malls, offices, airports.

Parameters

Items	VJ01NS7		Parameters	
Part Number	VJ01NS7	VJ01NS7	VJ01NS7	VJ01NS7
Beaming Angle (°)	170°	6800-7300		
CRI (Ra)	>70	>70	>70	>70
Luminous Flux (LM)	46	46	140	188
Luminous Efficacy (LMW)	150	150	150	150
Voltage (V)	DC24	DC24	DC24	DC24
Power (W)	0.36	0.72	1.08	1.44
Driving Method	Constant Voltage	Constant Voltage	Constant Voltage	Constant Voltage
Dimension (MM)	36*18*7.9	58*18*7.9	84*18*7.9	84*18*7.9
Working Tem (°C)	-25~+60	-25~+60	-25~+60	-25~+60
Storage Tem (°C)	-25~+70	-25~+70	-25~+70	-25~+70
Protection Grade	IP66	IP66	IP66	IP66

Dimension

www.vjledusa.com

02

SIGNS HAVE NEVER BEEN SO EASY

Beaming Angle

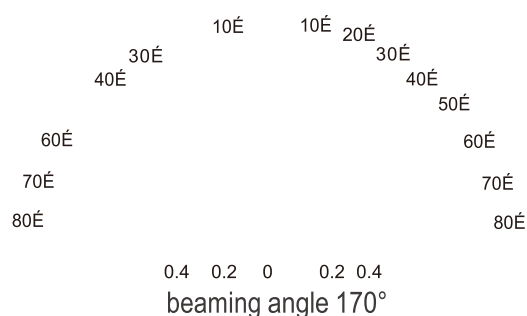

Reference Scheme

Part Number	Depth(MM)	On-Center Space mm(MM)	Density (PCS/M²)	Illuminance (Lux)	Power per (M²)
VJ01NS7	Dz=30	Dx=50 Dy=50	400	95000-10500	144
	Dz=40	Dx=75 Dy=75	169	4500-5000	61
	Dz=50	Dx=100 Dy=75	130	3000-3500	47
	Dz=60	Dx=120 Dy=75	104	2200-2800	38
Part Number	Depth(MM)	On-Center Space mm(MM)	Density (PCS/M²)	Illuminance (Lux)	Power per (M²)
	Dz=40	Dx=75 Dy=50	260	12000-13000	187
	Dz=50	Dx=100 Dy=75	130	5800-6500	94
	Dz=60	Dx=140 Dy=95	70	2800-3300	50
	Dz=70	Dx=140 Dy=95	60	2300-2500	43

Part Number	Depth(MM)	On-Center Space mm(MM)	Density (PCS/M²)	Illuminance (Lux)	Power per (M²)
VJ03NS7	Dz=50	Dx=100 Dy=95	100	6300-6800	108
	Dz=60	Dx=125 Dy=95	80	5300-5800	86
	Dz=70	Dx=150 Dy=95	70	4200-4600	76
	Dz=80	Dx=185 Dy=95	50	2200-2500	54

- Remark:
- 1. The transmittance of the advertising fabric was 56%.
 - 2. The above data is for reference only.

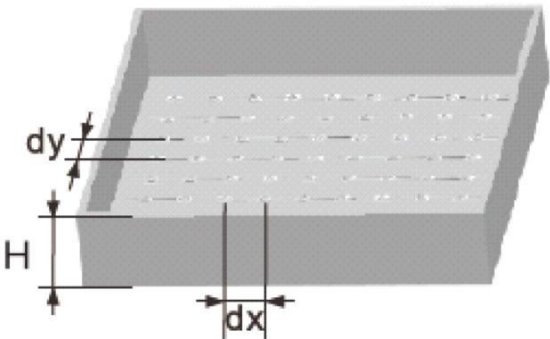

Wire Connection

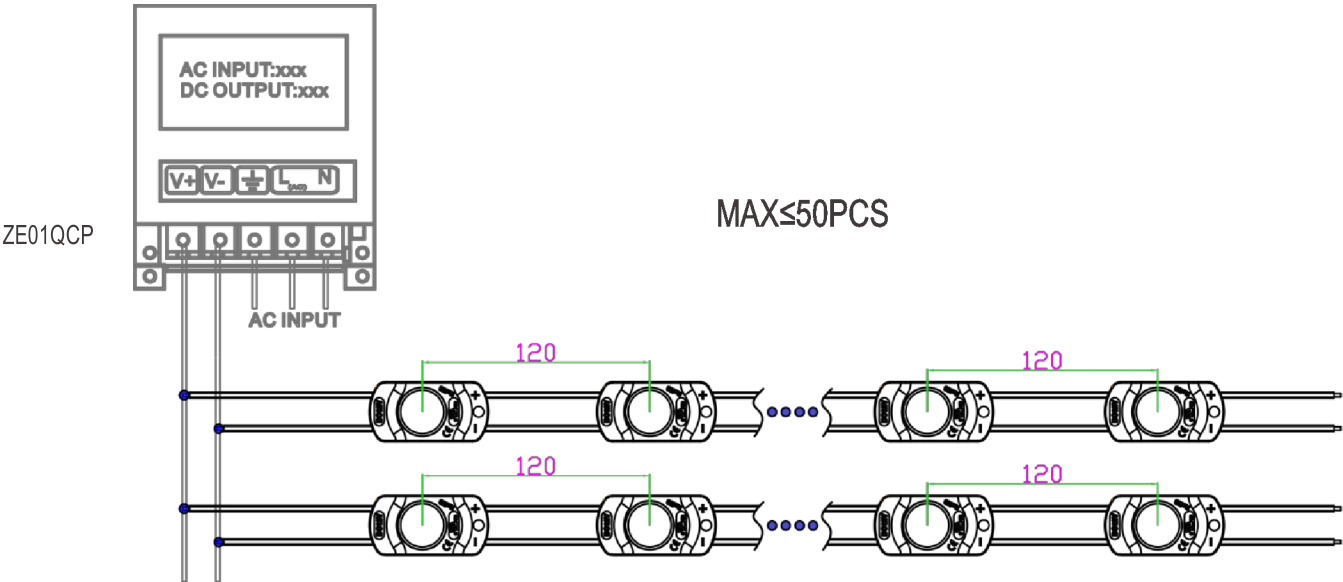

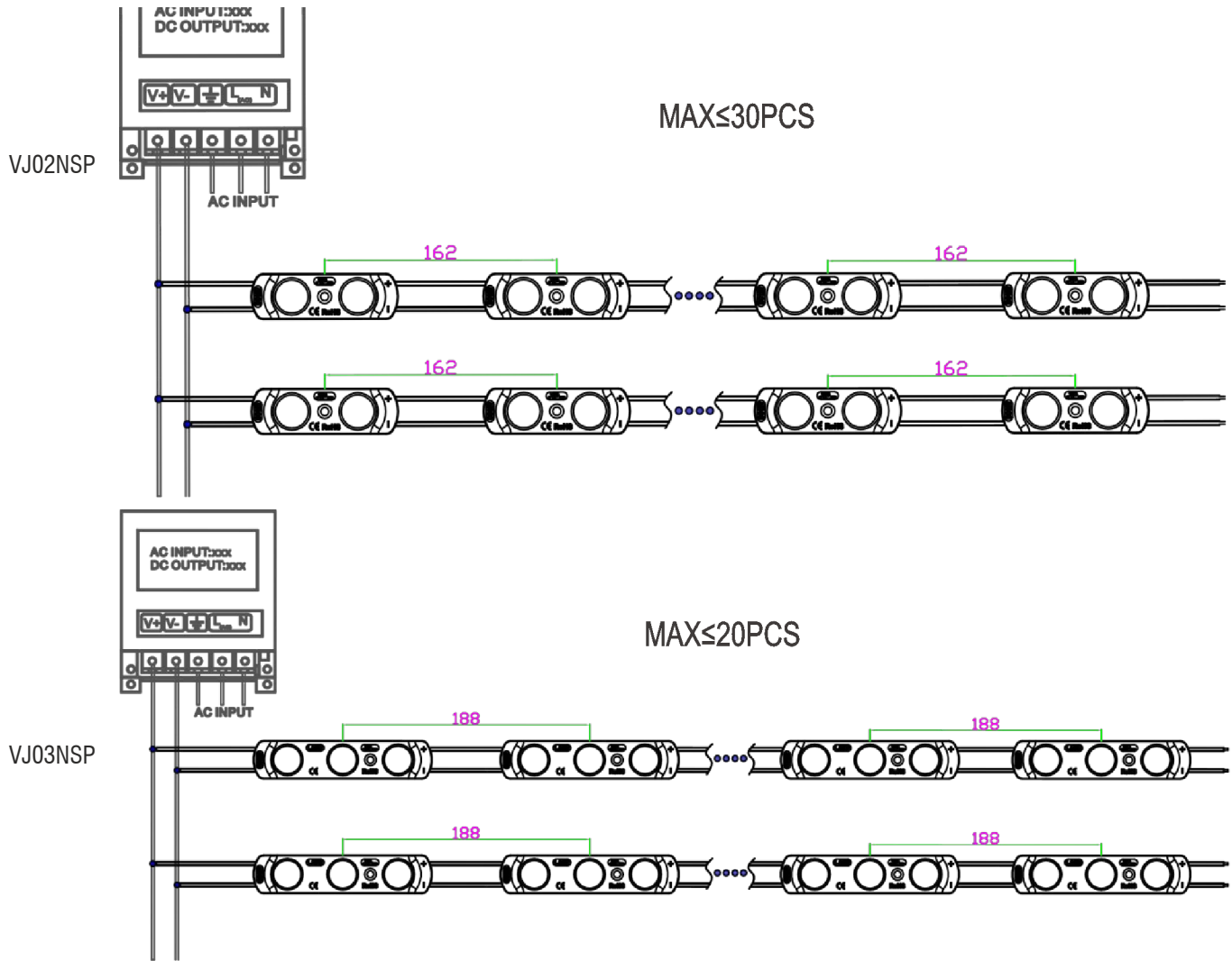

Packing

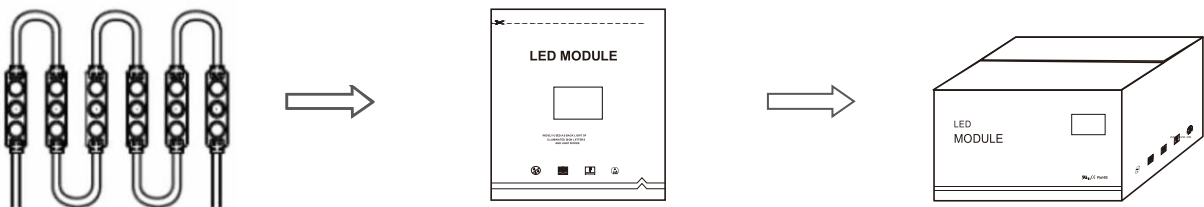

VJ01NS7 50 pcs per String
 VJ02NS7 30 pcs per String
 VJ03NS7 20 pcs per String
 VJ04NS7 20 pcs per String

100pcs in per bag
 120pcs in per bag
 100pcs in per bag
 100pcs in per bag

1800 pcs in a carton
 1200 pcs in a carton
 1000 pcs in a carton
 1000 pcs in a carton

Packing Specification

- Antistatic bag adopted
- Packing information

Part Number	VJ01NSP	VJ01NSP	VJ01NSP
Carton Dimension(MM)	490*450*220	490*450*220	490*450*220
Bags Per Carton (PCS)	18	10	10
Quantity Per (PCS)	1800	1200	1000
Net Weight (kg)	11.7(1+10%)	12.48(1+10%)	13.5(1+10%)
Gross Weight(kg)	12.7(1+10%)	13.48(1+10%)	14.5(1+10%)

Due to the packing manner difference, please adhere to the original products in case of discrepancy found between the picture and actual product

Self-provided tools & material

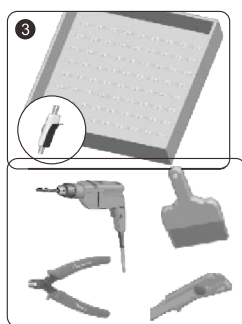

Dust brush, cutter, pencil, wire stripper, and drill

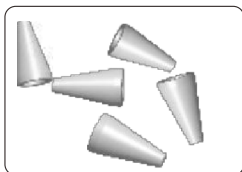

Wire Connector (Standard)

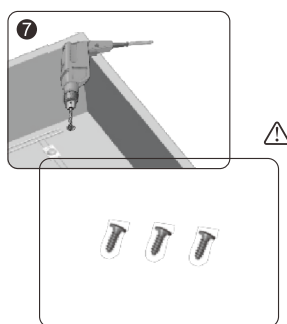

Screw

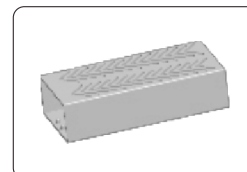

Power Supply

Installation Guidance

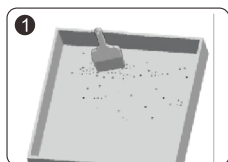

- Clean inside the light box.

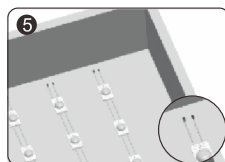

Strip the end wire for 10mm and cap with the wire connector. Waterproof and anti-corrosion must be done on the connectors.

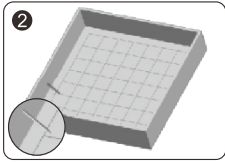

- Determine the appropriate layout.

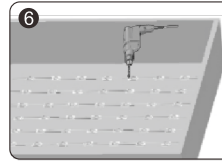

- Locate modules in the optimal position and secure with screws or neutral glass cement, which should be applied at the edge of the modules.

⚠ Note: Avoid breaking the module and wire when fixing with a drill.

- Drill a hole for connecting power cable. Fixation and protection for the cable must be done on the hole.

Note: Avoid breaking the light box in drilling the hole.

- Connect to the power cable and make sure that the polarity for connection is correct

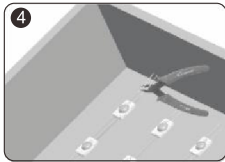

- Remove the unneeded modules.

⚠ Note: Cut in the middle position of the wires between modules.

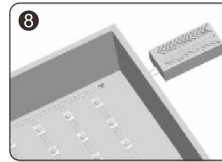

⚠ A Note: Red wire is positive and black wire is negative.

Instructions

1. Make sure the input voltage is sufficient 12V.
2. Disassembling or modifying the product is not allowed.
3. Installation with power on is not allowed.
4. Any organic solvent chemical is not allowed.
Acidic or alkaline adhesive is not allowed when install, neutral glass cement could be used for installation purpose, make it drying in 5. open environment for four hours.
6. Isolation and corrosion prevention on all wiring points and wire ends.
7. Make sure the power wire is thick enough and ensure the input voltage and connections are correct before power on.
8. This product should be used in a sign, do not expose it in opening site.
9. Installation and maintaining should be done by professional staff.
10. When connecting products, use standard daisy-chain connections. Do not exceed the recommended series connection (it is suggested to provide power from both ends when cascading 20 devices).
11. If the power cable for the extended module needs to be lengthened, use wire with a gauge of 18AWG (cross-sectional area of 0.75 square millimeters) or thicker to avoid overheating caused by excessive current, which can lead to adverse consequences.

Declaration

1. Warranty: 10years.
2. In order to ensure the safety, the broken wires need to be replaced by the manufacturer or the service agent, or by the staff with the similar qualification.
3. The given data in the specification was based on the laboratory testing, there may be discrepancy found in the actual products.
4. The given drawings in the specification are only for reference, there may be discrepancy found in the actual products.
5. The products are subject to change without prior notification.

01. Layout Density Guidelines

Use recommended length for pitch between each module to achieve optimum lighting output while maintaining lowest unit cost, This may be some differences by optical transmission rate of the PC.

(A) Recommended Pitch(P) per Depth(D)

3 LED Modul(General Type)

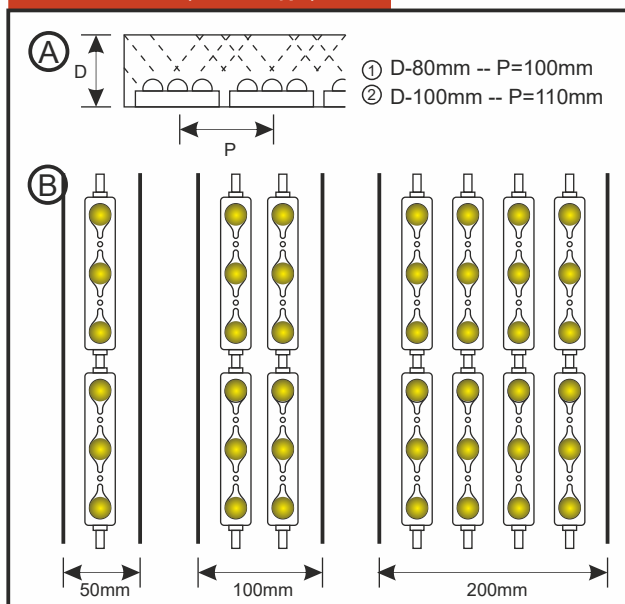

(B) Recommended Layout Density per Channel width

3 LED Modul(General Type)

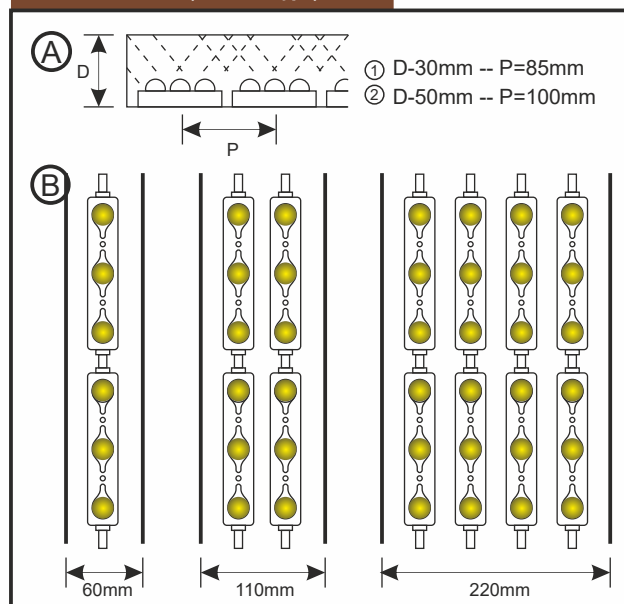

02. Connection Guide with POWER SUPPLY

Maximum driver quantity per serial string module is limited.

Using more quantity per string module will cause overloaded from SMPS which damages all connected products.

This will cause voltage drop and also dimmed lighting output.

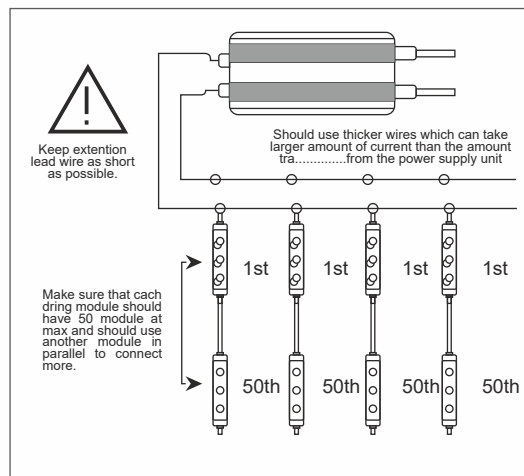

SMPS(W)	100W	150W	200W	300W
LED Module				
1LED module	118EA	177EA	236EA	354EA
2LED MINI module	118EA	177EA	236EA	354EA
3LED module	78EA	118EA	157EA	236EA
4LED module	39EA	59EA	78EA	118EA



Maximum quantity for LED module is based on 85% of specified capacity of power supplies for extended lifespan.

INSTALLATION GUIDE FOR LED MODULES

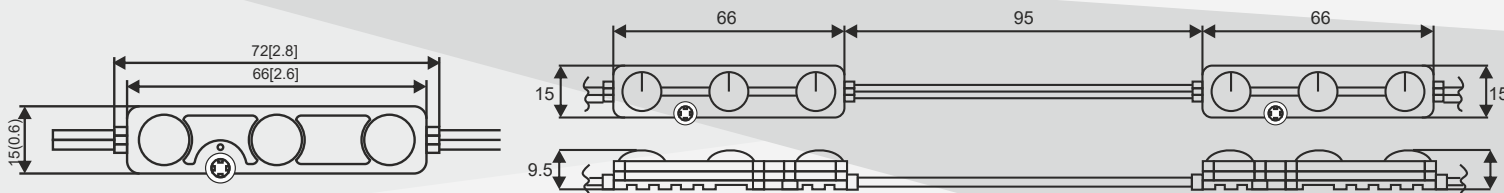

Cell: 848-350-2833

www.vjledusa.com contact@vjledusa.com



www.facebook.com/vjledusa



[@vjledusa](https://www.instagram.com/vjledusa)